

ifm electronic

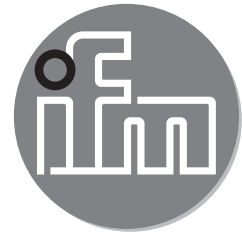

Installation Instructions
Aseptoflex adapter

UK

E330xx / E331xx

05/2011

706008/00

Mount

- adapter (C) to sensor (A) first,
- then sensor + adapter to the process connection by means of a nut, a clamping flange or similar (B).

If it is not possible to slide the fixing element (B) down over the top of the sensor: slide it up over the bottom of the sensor before the adapter is mounted.

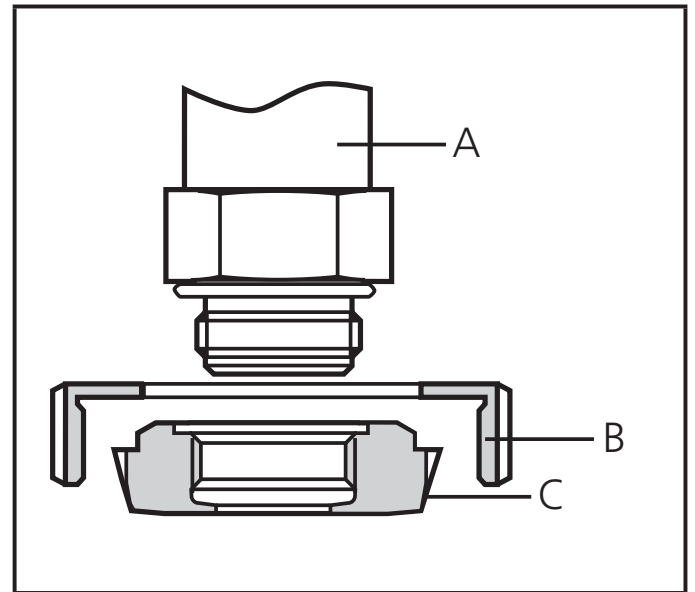

NOTE: A guarantee for a long-term stable and maintenance-free fitting, with no bug traps in the hygienic sealing of the metal seal (Aseptoflex connection) is only valid for once-only mounting.

Mounting of the adapter:

- Slightly grease the threads and sealing areas of the sensor and adapter with the lubricating paste (1). The paste must be suitable and approved for the application and compatible with the elastomers used.

Recommendation: Klüber paste UH1 84-201 with USDA-H1 approval for the food industry.

- Make sure that the O-ring (D) is correctly positioned.

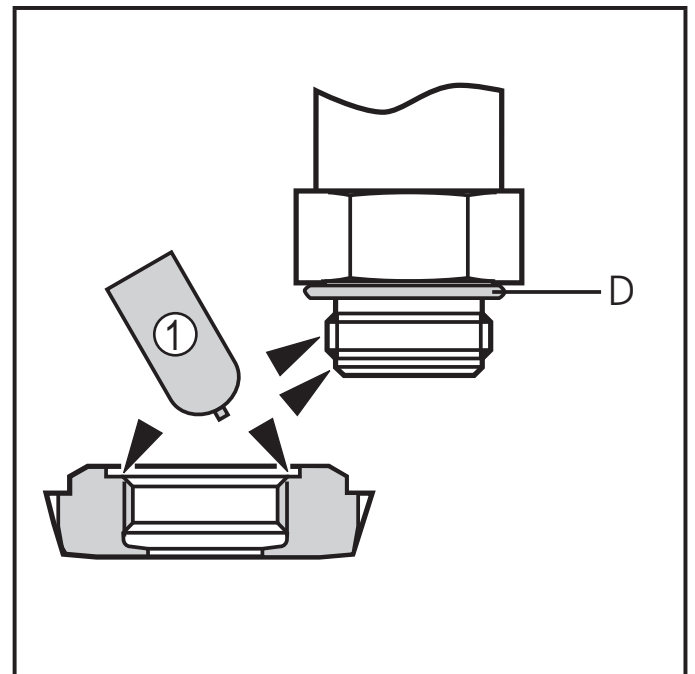

- Screw the sensor into the adapter until it is hand-tight. Do not damage the sealing chamfers.

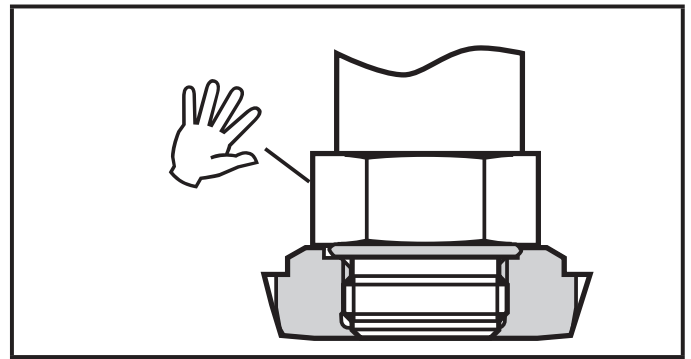

- Clamp the sensor + adapter into a clamping device (E). The sealing chamfers (F) must not be damaged.
- Tighten the sensor using a spanner until you can feel the end stop (this corresponds to a maximum tightening torque of 25 Nm / 18 ft-lb).
Note: Further tightening may affect the sealing effect.

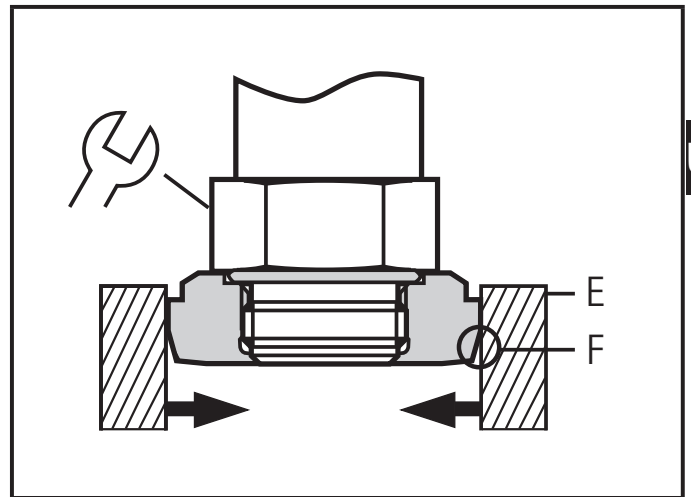

UK